

**Site Info:**

**RAWENE HOSPITAL – 09 405 7709**  
163 Parnell Street Rawene  
Private Bag 753 Kaikohe 0440

**Emergency Phone: 111 OR ring 09 405 7709 x801.** This will take you through to the ward. State the problem, location and the on-site Medical Team will come and assist. Medical Team will decide if Heli-med transfer is required or safe to transport by road. Notify Service Manager/Cardiologist/CNM of incident. Complete a datix

**Fire Assembly Point:** At front of main entrance

**Closest ED:**

**In Hospital**

**Clinical Service Manager:**

**Sophie Titore: Direct Dial 09 405 7325 Mobile 021 027 825 32**

Below is Rawene Hospital and the arrow indicates where the caravan plug is and where the van will be parked



**KAITAIA HOSPITAL – 09408 9180**  
29 Redan Road, Kaitaia 0410  
Private Bag

**Emergency Phone:** The Diagnostic van plug is by the Whanau Room outside the main entrance to Kaitaia Hospital. Request assistance from Emergency Department Kaitaia Hospital. Notify Service Manager/Cardiologist/CNM of incident. Complete a datix

**Fire Assembly Point:** At front of main entrance

**Closest ED:**

**In Hospital, ground floor by main entrance**

**Operations Manager:**

**Neta Smith: Mobile 021 463 438**

Highlighted areas are the evacuation points

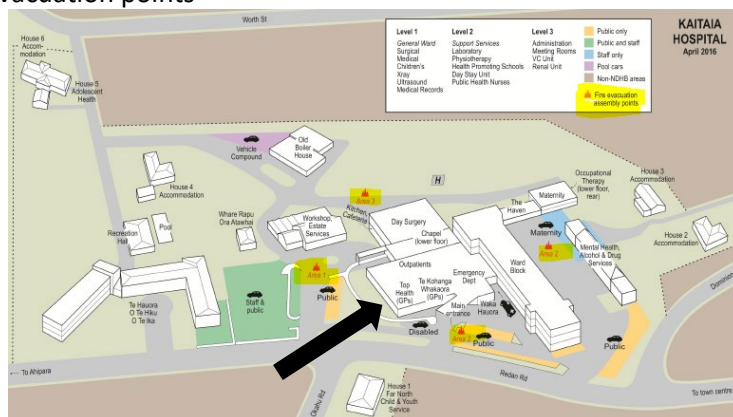

**Kaikohe** - 09 404 0280 x5871  
4 Station Road Kaikohe 0450

**Emergency Phone: 111 OR** ring 111 ask for Ambulance, state location and problem. Ambulance will transfer patient to the nearest Hospital where the medical team will decide if Heli-med transfer is required or safe to transport by road. It is possible for Ambulance staff to notify Heli-med and transfer to nearest Secondary Care Hospital. Notify Service Manager/Cardiologist/CNM of incident. Complete a datix

**Fire Assembly Point:** Highlighted area car park

**Closest ED:**

**Bay of Islands Hospital**

**Clinical Team Manager:**

**Jacqui Hessell: Mobile 021 834 588**

Highlighted area is where the Diagnostic Van's plug will be situated within the old NorthTec Kaikohe Campus

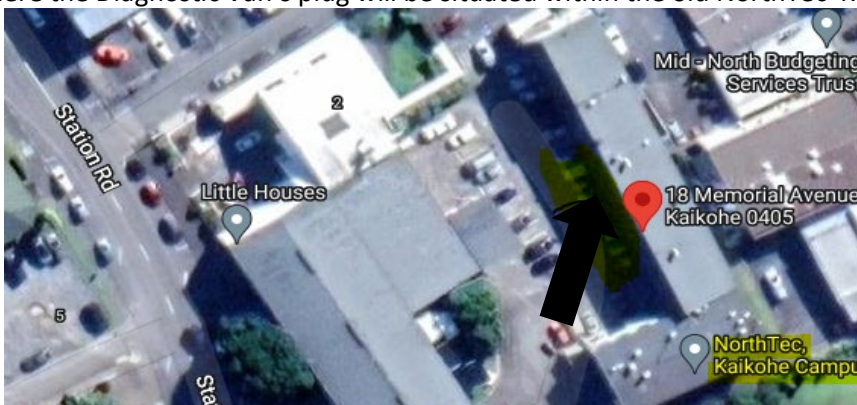

**Dargaville** - Phone: 09 439 3330  
77 Awakino Road, Dargaville 0310

**Emergency Phone: 111 OR** ring 111, ask for Ambulance, state location and problem. Ambulance will transfer patient to the nearest Hospital or to the Dargaville Medical Centre where the medical team will decide if Heli-med transfer is required or safe to transport by road. It is possible Ambulance staff may notify Heli-med and transfer to nearest Secondary Care Hospital. Notify Service Manager/Cardiologist/CNM of incident. Complete a datix

**Fire Assembly Point:**

**Main entrance**

**Closest ED:**

**Dargaville Hospital Medical Centre**

**Clinical Nurse Manager:**

**Karen Kapiti Mobile 021 418 511** Highlight areas for evacuation and where the van will be located

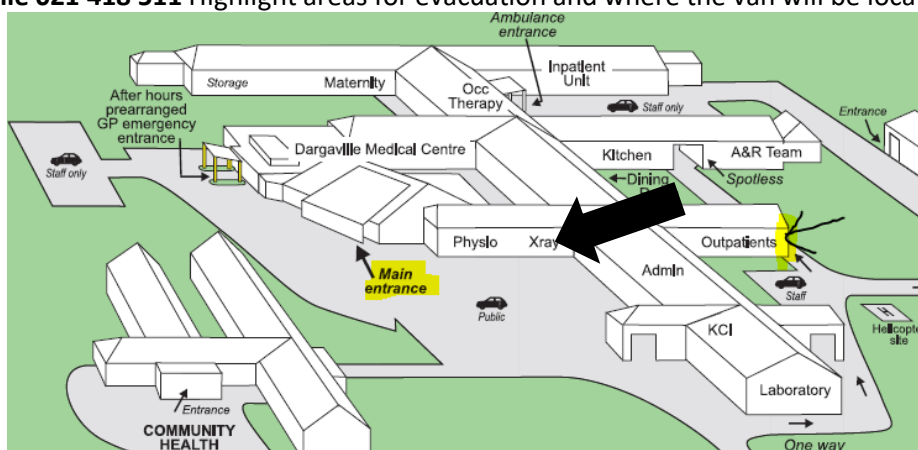

## Kawakawa

Ngati Hine and BOI Hospital (located at new build)  
2/4 Rayner Street  
Kawakawa 0210

### BOI Hospital plug – not sited March'24

There are two plugs at Kawakawa

1. One plug at Bay of Islands Hospital. Located at the new build alongside the Surgical Bus 32 amp. This plug is not confirmed
2. Other plug at Ngati Hine Trust at main entrance

### Contact person

#### Ngati Hine

- Clinical Nurse Lead
- 0273583010

#### BOI Hospital

- Jen Thomas (Operation Manager)
- 021427152

### Emergency

- **Phone 111** ask for Ambulance, state location and problem.
- Ambulance will transfer patient to the nearest Hospital where the medical team will decide if Heli-med transfer is required or safe to transport by road.
- **Or** Ambulance staff will notify Heli-med with possible helimed retrieval. In this case the ambulance will transport the patient to where the Helicopter lands.
- Notify Service Manager/Service Clinical Lead e.g. Cardiologist/CNM of incident.
- Complete a datix

### Fire Assembly Point:

- Ngati Hine - Parking area outside main building if safe

### Closest ED:

- BOI Hospital.
- Please see photos below to help locate the plug and instruct your patients where to go
- If there is a **meter attached** to the plug, please record the number in the notebook provided in the cab of the van
- Request secure overnight parking at the rear of the Ngati Hine building
- The plug site for the van is at the entrance to Ngati Hine Trust, on the left of the steps as you ascend to go into the building. Ngati Hine is on the left as you head out of Kawakawa heading North.
- Please make sure you take the **meter reading** at the commencement and end of your clinic

### Ngati Hine



**Te Kao** - Phone: 09 409 7880

- Whakawhiti Ora Pai Community Health Centre in Te Kao
- 6652 Far North Road, Te Kao 0484
- 3 clinics in Te Hapua, Te Kao and Pukenui . The van will go to Te Kao

**Emergency Phone: 111 and** ask for Ambulance, state location and problem. Ambulance will transfer patient to the nearest Hospital where the medical team will decide if Heli-med transfer is required or safe to transport by road. It is also possible for Ambulance staff to notify Heli-med and transfer to nearest Secondary Care Hospital. In Te Kao, the Ambulance will transport the patient to where the Helicopter lands. Notify Service Manager/Cardiologist/CNM of incident. Complete a datix

**Fire Assembly Point:**

Car Park main entrance

**Closest ED:**

Kaitaia Hospital

**Clinical Nurse Manager:**

Ask for CNM

09 409 7880 x203

Arrow indicates the plug is at the back of the Health Clinic. It is advised to reverse around to the back. Highlighted area shows evacuation point





## Kerikeri

St Johns  
361 Kerikeri Road  
Kerikeri 0230

- No contact person

### Emergency

- **Phone111** ask for Ambulance, state location and problem.
- Ambulance will transfer patient to the nearest Hospital where the medical team will decide if Heli-med transfer is required or safe to transport by road.
- **Or** Ambulance staff will notify Heli-med with possible helimed retrieval. In this case the ambulance will transport the patient to where the Helicopter lands.
- Notify Service Manager/Service Clinical Lead e.g. Cardiologist/CNM of incident.
- Complete a datix

### Fire Assembly Point:

Car Park main entrance

### Closest ED:

- BOI Hospital
- The Kerikeri plug location is situated alongside the St Johns Office on Kerikeri Rd, where the Breast Screening Bus sets up.
- Please see photos below to help locate the plug and instruct your patients where to go
- If there is a **meter attached** to the plug, please record the number in the notebook provided in the cab of the van
- Secure overnight parking maybe available in Kerikeri with the Community team where their covid offices are. Email Claire Forest for contact details [claire.forrest@northlanddhb.org.nz](mailto:claire.forrest@northlanddhb.org.nz)

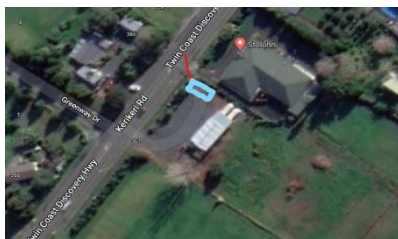

## Fonterra – for screening

State Highway 1

Kauri

- This plug is for screening and permission to locate here has to be obtained before any planning is undertaken. There are strict rules associated with Fonterra

### Contact person

- Sophie Adamson
- 0277066196

### Emergency

- **Phone111** ask for Ambulance, state location and problem.
- Ambulance will transfer patient to the nearest Hospital Whangarei.
- Notify Service Manager/Service Clinical Lead e.g. Cardiologist/CNM of incident.
- Complete a datix

### Fire Assembly Point:

- Main Road - Fonterra

### Closest ED:

- Whangarei Hospital.
- Please see photos below to help locate the plug and instruct your patients where to go
- If there is a **meter attached** to the plug, please record the number in the notebook provided in the cab of the van
- Secure overnight parking is just to the right of your plug
- Please sign in on day
- Please covid test and let Sophie know of your status. No +ve's allowed on site
- Please give at least 5 days-notice of who will be on site so the Office can be notified
- Toilets are inside the compound and instruction will be provided with you using them. There are tight infection control measures



## District Nursing Services

107 Mangawhai Heads Road  
Mangawhai

### Contact

Trish Wilson

Mobile: 021 243 5039

Good parking. Go around the back of the building and the plug is situated at the end of the ramp. Please ring Trish who will cone off the area. Drive straight into the park. Small waiting room just off the ramp that sits 2 people



## Te Whatu Ora

Commerce Street  
Whangarei

### Contact

Clinic reception and book the space. Commerce Street have requested that you park up no more than a week

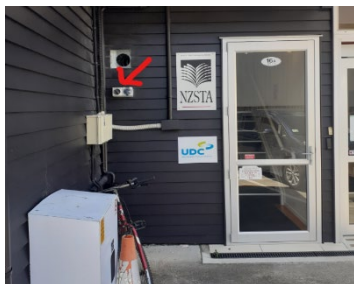

## Te Whatu Ora

SAU car park alongside Surgical Bus 32amp plug

Whangarei Hospital

Short term option

### Contact

- On-line booking form
- Calvin de Boer to cone off parking spaces night before and get permission from Vicky Taylor ACNM SAU

